

Grade K – Leaf Bowl



Clay Form

What do you see?



Deep Bowl, Jomon period in Japan, 5000-800 BCE

Artistic Focus: Clay Form



Deep Bowl,
Jomon period in Japan,
5000-800 BCE

FORM is a three-dimensional object that has height, length, width, and depth.

Today's objective:

1. Demonstrate basic construction of a clay slab leaf bowl
2. Demonstrate basic slab and texture techniques

WA State Visual Arts Standard

Demonstrate safe and proper procedures for using materials, tools, and equipment while making art. (VA:Cr2.2.1)

Region – East Asia

- This pot was from the people who lived in Japan during the Jomon period (5000-800 BCE)
- Pottery was characterized by impressions of rope on the surface of the pottery
- Early pottery in this region was made for storing items such as fresh water and marine organisms.



Japan



Technique – Slab with Texture

- **Slab-building** uses flat rolled-out pieces of clay to build an object.
- **Actual texture** is how something feels when you touch it.

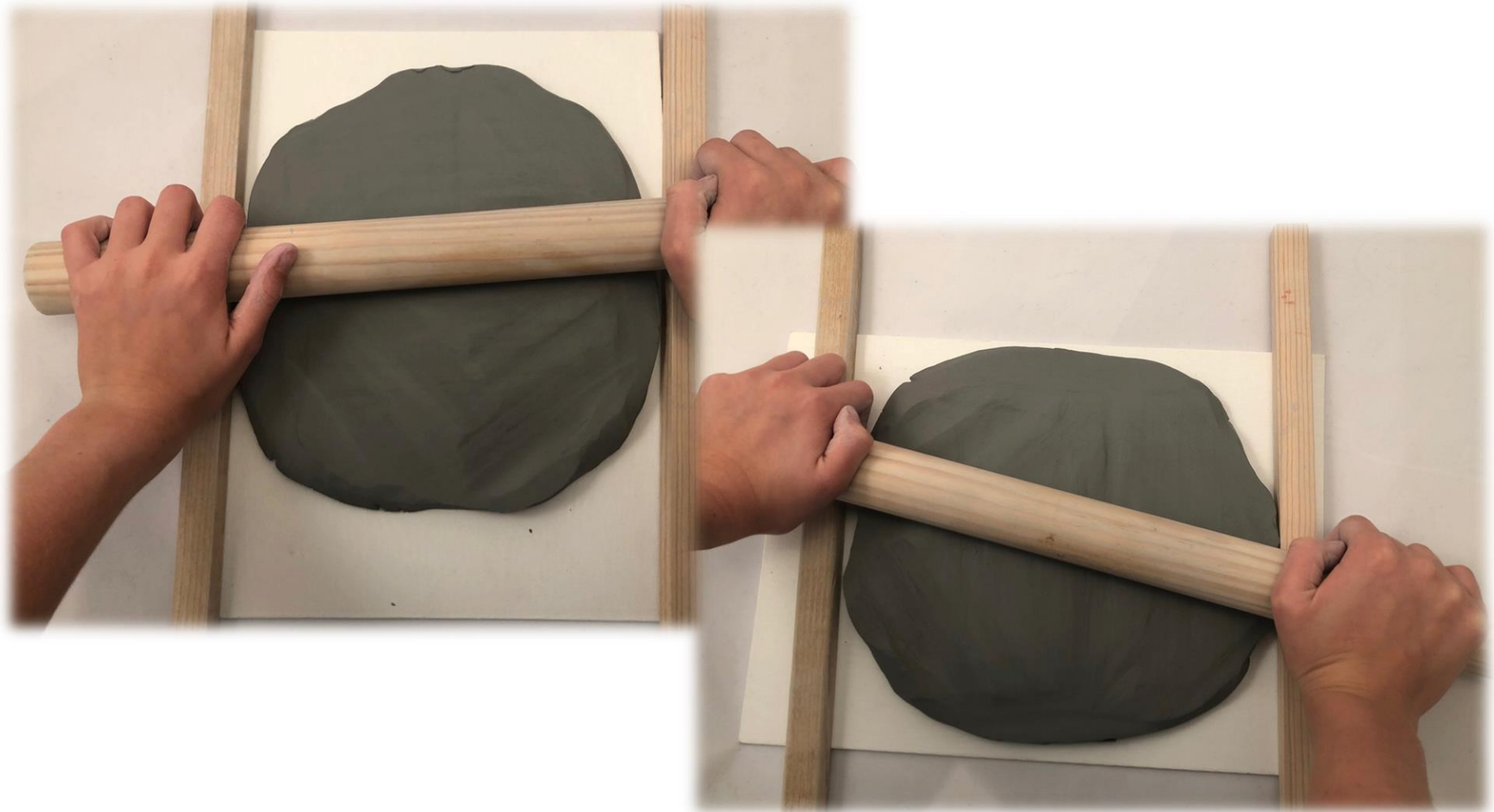

Slab with Texture Examples: Contemporary Art



Various Textured Porcelain Paperclay Glass Bowls



Clay Artist: Mairi Stone
Lives in Ireland (Europe)

“My work is all about trying to express my love... for the beauty of this earth.”

Slab with Texture Examples: Contemporary Art



Tiles, Mairi Stone

Example of Today's Project



Materials

Clay



Water



Paper bowl



Pattern / Leaf



Wooden skewer or tool



Thickness guide sticks



Work surface



Fettling knife



Roller



Scorer (wired texture tool)



Tool Safety Guidelines

To avoid injury, please follow these basic guidelines:

- Move the tools **slowly**.
- Avoid touching **the end** of the tools.
- **Watch** where your tools are when they are in your hands.
- Keep the tools flat on the **top of your desk** when not in use.
- **Do not walk** with the tools.

If you handle tools responsibly, you'll get to use them.



Step 1

- Place clay between guide sticks and start rolling out clay.
- Turn your board and move your guide sticks to the other side so you can roll out the clay evenly until it is the same thickness as the sticks.

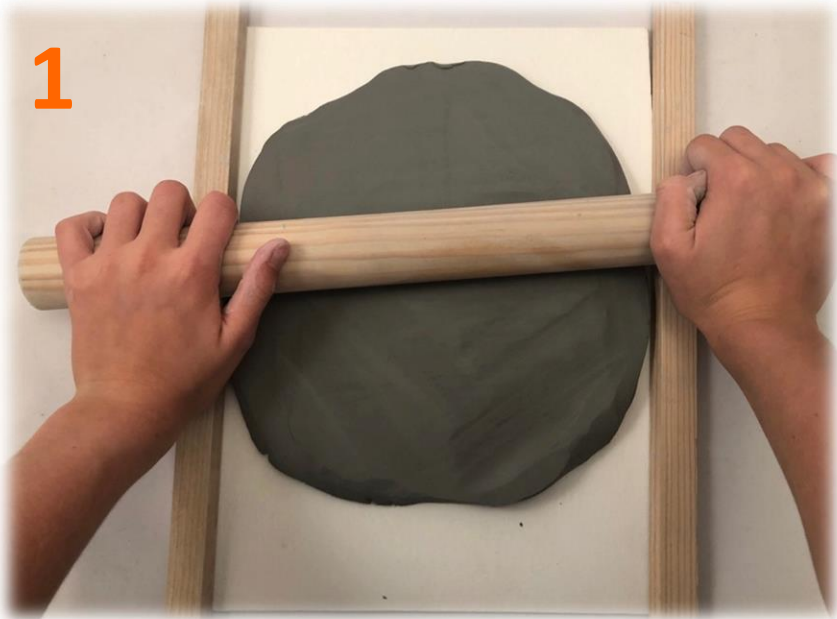

Step 2

- See if the leaf fits on your slab.
- Once your slab is rolled out, either push the texture of the leaf in with your warm hands or lightly roll over your leaf so it pushes the texture into the clay.



Step 3

- Hold a wooden skewer or tool straight up and down to cut around the leaf.
- Make sure the tip of the tool goes all the way down to the board.

1



2



3



4



Review of Steps 1-3

1



2



3



Review of Steps:

1. Roll slab
2. Roll leaf
3. Cut around leaf

Step 4

- Carefully remove the extra clay from around your leaf and set it to the side.
- If it doesn't peel away, you need to cut the clay all the way down to the board.

1



2



3



4



Step 5

1

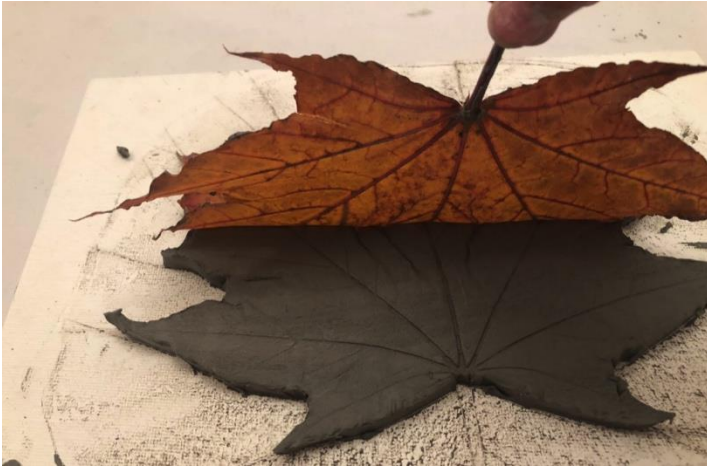

2



3



- Peel off the leaf from your clay shape.
- Carefully put a little water on your finger and smooth the sides of your leaf.

Step 6

While you are working, **an adult** will come by and write your initials on the bottom of your leaf:

1. Your teacher's last initial.
2. Your initials (the first letter of your first and last names).

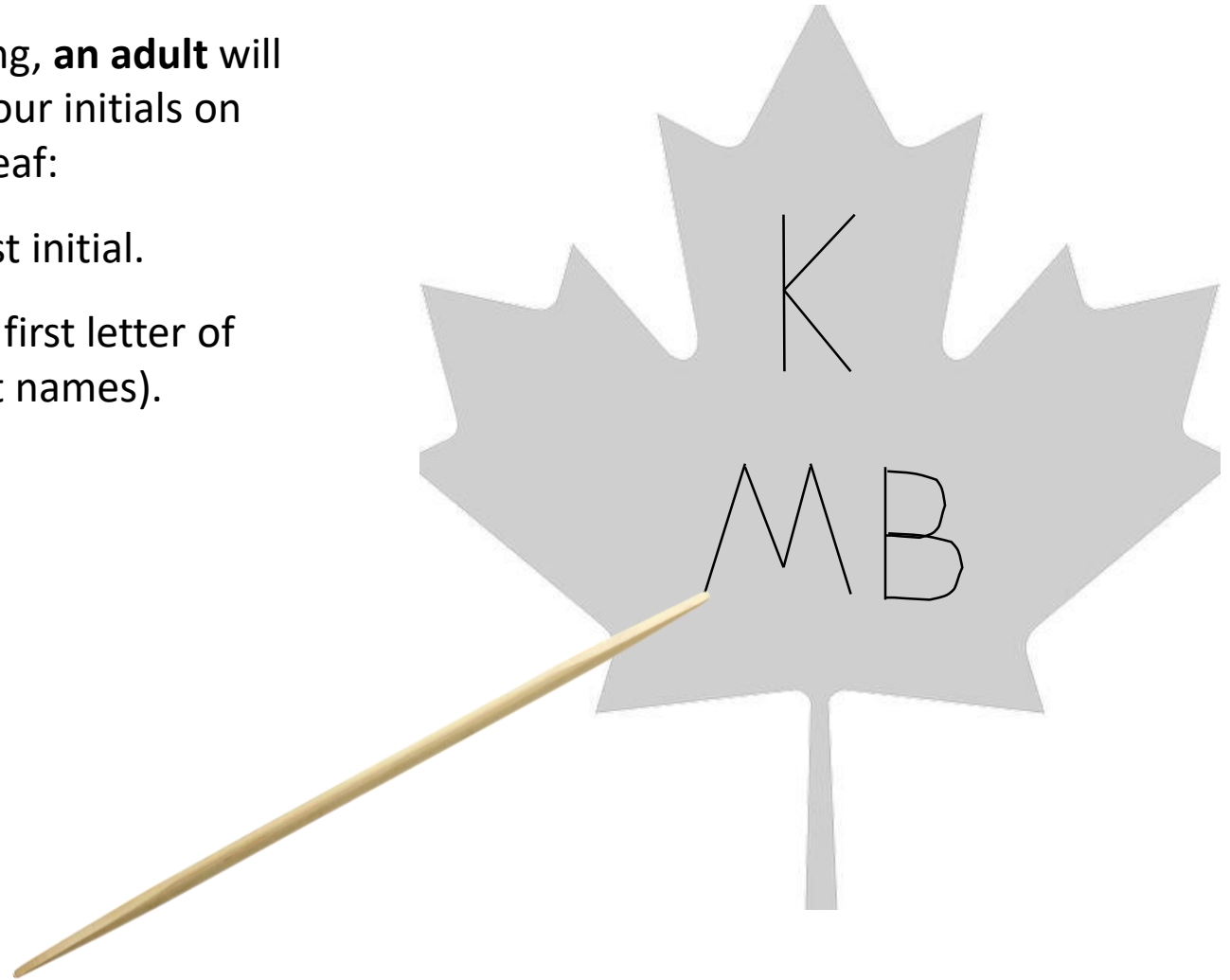

Review of Steps 4-6

4



5

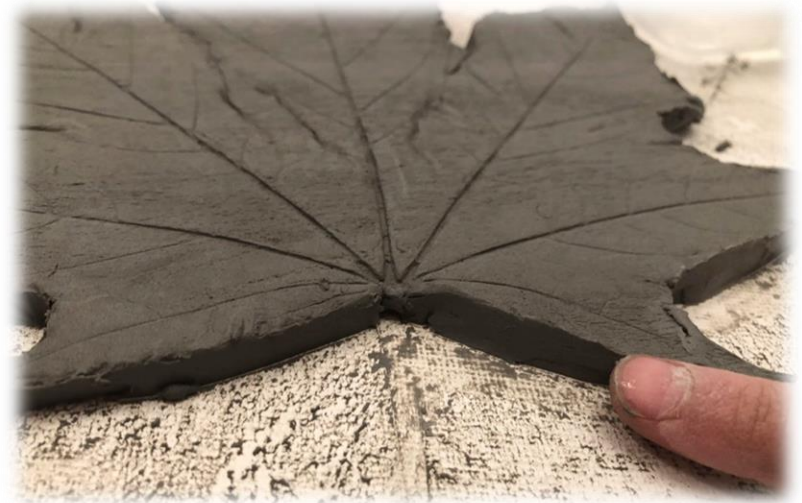

6



Review of Steps:

4. Remove extra clay
5. Smooth sides with water
6. Have an adult add initials

Step 7

- Carefully place clay leaf in a bowl so it can dry. Set your bowl to the side.

1



2



3



4



Step 8

- After you've made your clay leaf, use your extra clay to make a small critter to put on top of it.
- Try to make your critter out of one whole piece of clay.



Step 8 continued

Which critter will you choose to add to your leaf?



Step 8 continued

TIP – Your parts must be thicker than your thumb.



Step 9

- Set your critter in the leaf bowl.
- Raise your hand to let an adult know you are done.



Reflection

- What did you think about building a clay form?
- What technique did we learn about today?
- What did you think about the technique we learned?
- What did you find challenging?
- What was your favorite part of our project today?



Credits

1. https://en.wikipedia.org/wiki/Pottery#Early_pottery
2. <https://www.proprofs.com/flashcards/cardshowall.php?title=art-history-209-midterm-1> Deep bowl from Jomon Period
3. <https://geology.com/world/> World map
4. https://www.instagram.com/mairi_stone/
<https://www.etsy.com/ie/shop/mairistone> Mairi Stone Ceramics
5. https://www.tnm.jp/modules/r_free_page/index.php?id=1906&lang=en Tokyo national Museum
6. Original LWSD sample art, used with permission.